

04 IXORA / BUNGALOW Type T2 - PLAIN-PIED - SURFACE D'EMPRISE AU SOL : 54,7 m²

Toiture 4 pans, terrasse

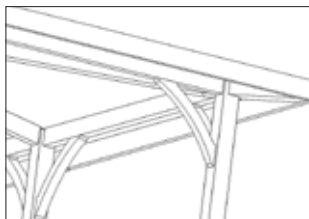
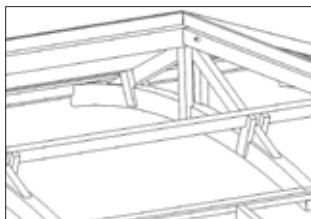
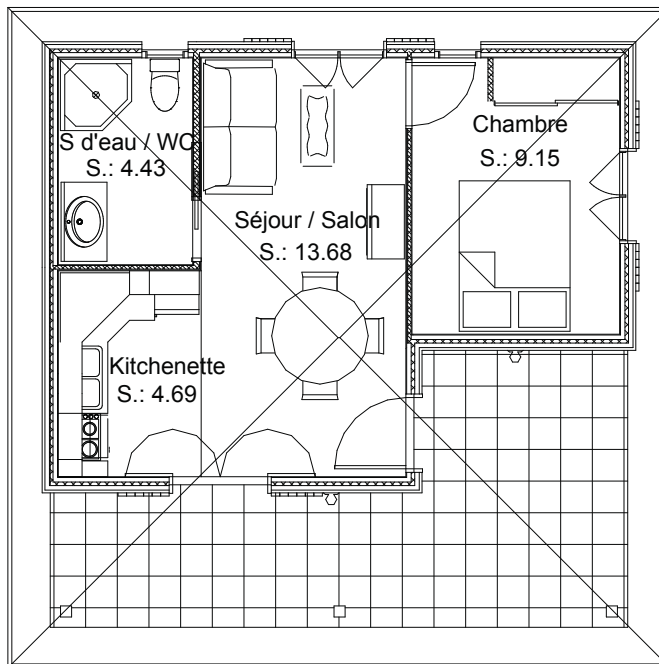

PROGRAMMATION / SURFACE DE PLANCHER (TAXABLE) : 32,7 m² - SURFACE HABITABLE : 32 m²

◆ SEJOUR / SALON :	13,68 m ²
◆ KITCHENETTE :	4,69 m ²
◆ CHAMBRE :	9,15 m ²

◆ SALLE D'EAU / WC :	4,43 m ²
◆ TERRASSE :	17,06 m ²